

BARFIDE

INSTRUCTION MANUAL SPO



 **SUMEC**

Table of contents

| | | |
|------------|---|-----------|
| 1. | Foreword | 2 |
| 2. | Disclaimer | 2 |
| 3. | Declaration of conformity | 3 |
| 4. | Generality | 4 |
| 5. | Signage | 4 |
| 6. | Funtcion | 4 |
| 7. | Characteristics | 5 |
| 8. | Installation instructions | 7 |
| 9. | Power On | 8 |
| 10. | Set up and production start up | 8 |
| 11. | Maintenance | 9 |
| 12. | Power supply options | 9 |
| 13. | Accessories | 9 |
| 14. | Spare parts | 10 |
| 15. | Electrical diagram | 10 |
| 16. | Safety | 10 |
| 17. | Transport and handling | 11 |

1. Foreword

This manual is intended for the various persons who have to work on the product, in order to provide them with the information they need.

In particular, it includes information on:

- security;
- the installation of the product;
- the use of the product;

As well as the diagrams, drawings and useful documents in the appendix.

2. Disclaimer

Any copying or reproduction, even partial, by any means whatsoever, as well as any total or partial transcription, without ERRIC's consent, is prohibited (Law No. 57 298 of 11.03.57).

Despite all the care taken in preparing this document, ERRIC cannot guarantee the accuracy of all the information it contains. In particular, your partly completed machine may differ, in certain respects, from the figures presented in this manual. However, this does not affect the operation of the machine.

The provision of one or a set of documents whose index has been increased commits you to destroy all documents with a lower index (originals and copies).

This manual is essential for the safe handling of the machine. It is necessary to keep it, as a reference, at all times near the machine.

This document includes the safety rules and procedures to be followed when using the machine. Therefore, please read this document before using the machine.

3. Declaration of conformity

DECLARATION OF INCORPORATION OF A PARTLY COMPLETED MACHINE

Extract from Directive 2006-42 "Rules for Machinery Article 2 §g (Definitions)

"Quasi-machine": a set that almost constitutes a machine, but which cannot provide a defined application on its own. A drive system is a partly completed machine.

The quasi-machine is intended solely to be incorporated or assembled with other machinery or other quasi-machinery or equipment in order to constitute a machine to which this Directive applies.

We, the undersigned

ERRIC

265 rue de la Grange
74950 SCIONZIER
France

Declare that the equipment:

Bucket separator
Type: SP0

Complies with all the provisions of Directive 2006/42/EC relating to machinery, and conforms to the following harmonized standards:

- EN 14121-1 and 2
- EN 12100-1 and 2
- EN 13849-1 and 2

Meets all the provisions of Directive 2006/42/EC relating to machinery, and complies with the following harmonised standards:

Done at Scionzier on : 01/12/20

M DUFOUR, CEO :



4. Generality

In order not to impair product operations or endanger personnel, the following rules must be observed:

- Read the manual carefully before performing any operations.
- Never lean on the product
- Never subject the product to any shock.
- Never immerse the product
- Never spray liquids on the product
- Safety devices may only be dismantled by authorized personnel and replaced by an identical system

- Inhibition or forcing of a sensor that could lead to unexpected actions is forbidden on any unqualified person.

The customer is responsible for wiring the power supply and its 300mA protection

The proper maintenance of the product as well as the replacement of worn parts is the responsibility of the customer and his maintenance personnel.

Dangerous and/or flammable substances use by the customer are not the responsibility of ERRIC, but must be taken care of by the customer

The company ERRIC cannot be held responsible for interventions that have been carried out

5. Signage

Type : SP0

- Serial number :
- Date of manufacture :
- Manufacturer :

6. Function

Turntable for recovering parts at the machine exit and for separating control parts.

The parts recovery disc is divided into six baskets, each with a cavity for recovering production parts and a second, smaller cavity for separating control parts.

The whole unit is resistant to cutting oils and swarf, and can be integrated into machining equipment.

The upper part is interchangeable to suit different part sizes.

The separator is electrically driven, with a 24Vdc power supply. Power can be supplied directly by the machining equipment, by a 200Vac/24Vdc transformer or directly by a 220V socket.

7. Characteristics

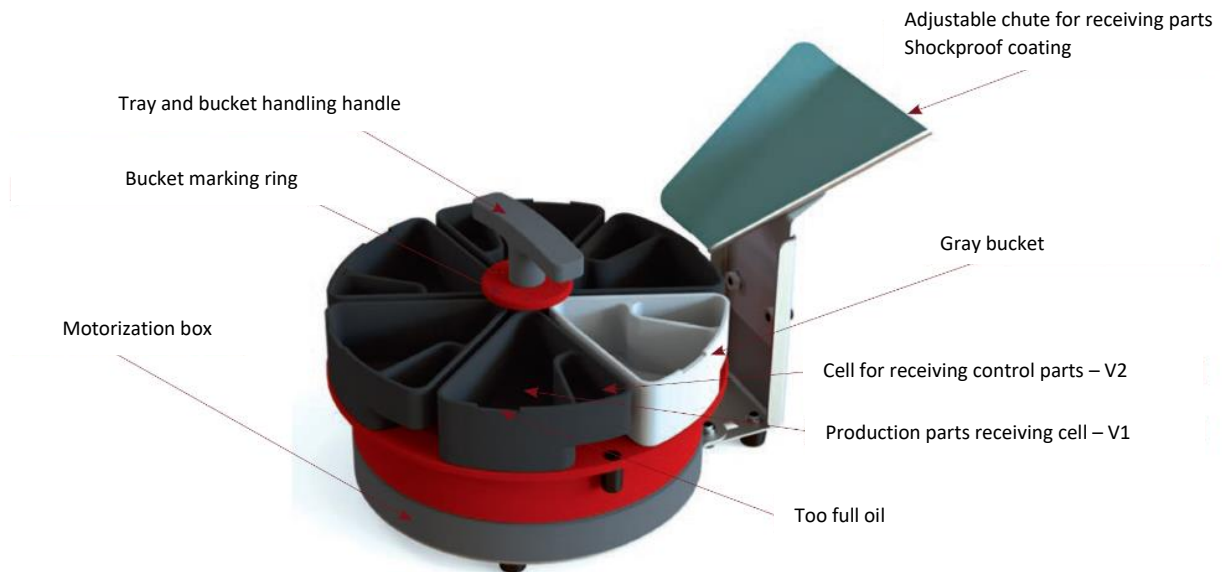

| Electricity | |
|---|---|
| Frequency | Direct current |
| Nominal voltage | 24V |
| Presence of neutral at product power supply | YES |
| Maximum power | 50VA |
| Connection | Cable M12 5 pôles Mâle 5m 5x0.34 ² |
| Pollutions | |
| Atmosphéric | NO |
| Sound | 78dBa maximum |
| Vibrations | NO |

The product is designed to operate under the normal conditions of an industrial production workshop. The elements have been selected to meet the constraints imposed, but require regular maintenance.

Overcurrent protection must be placed by the customer and calculated with the maximum power above.

Noise pollution Our machines are not subject to the installation of an acoustic enclosure.

All the components of the machine do not generate a sound pressure higher than 78dBa and comply with CE standards.

Noise from sources other than our equipment is not our responsibility.

Vibration

Our machines are not subject to vibrations.

Quality

The product is tested and run for 48 hours in the company before being shipped.

SP0 features

- Red and grey anodized aluminum drive unit.
- 24Vdc motorization.
- Separate control box.
- Mobile tray with integrated sampling buckets.
- Three possible configurations: Ø125 / Ø150 / Ø180mm.
- Adjustable ramp.
- Maximum speed: 3 seconds/piece.
- Bulk storage with shock tolerance between parts.
- Minimum part dimensions: Ø1mm length 1mm.
- Maximum part dimensions: Ø5mm length 15mm. (depending on tray Ø and cup reference).
- Overall size :

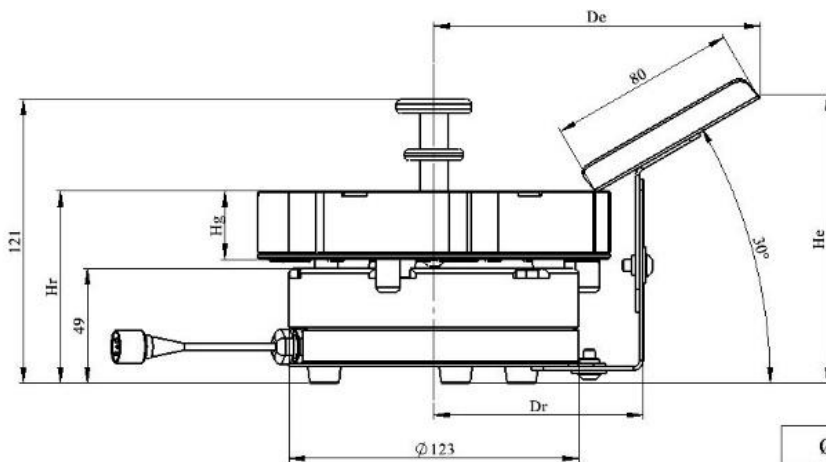

| ØP | Ø 125mm | Ø 150mm | Ø 180mm |
|----|-------------------|-------------------|-------------------|
| Hg | 30mm | 40mm | |
| Hr | 85mm | 95mm | |
| He | 125mm | 135mm | |
| Dr | 76.5mm | 89mm | 104mm |
| De | 126.5mm | 139mm | 154mm |
| V1 | 20cm ³ | 32cm ³ | 65cm ³ |
| V2 | 3cm ³ | 8cm ³ | 15cm ³ |

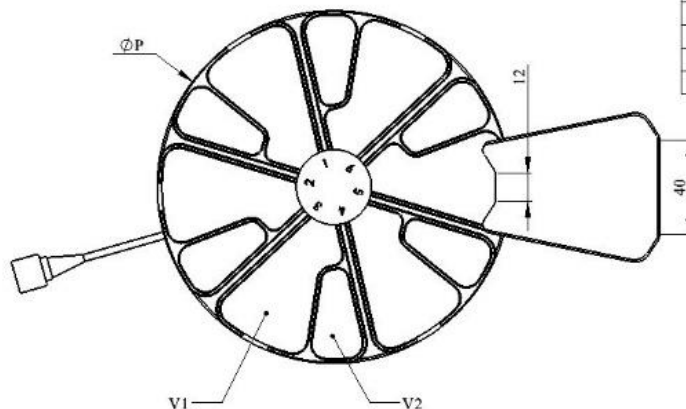

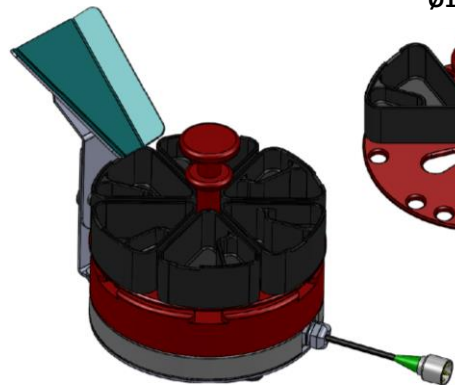
Trays :
Range available SP0

 Tray SP0
 Ø125 - 6 - 30

 Tray SP0
 Ø150 - 6 - 30

Complete set SP0 with :

- Red anodized aluminium tray
- Plastic buckets
- Treated ramp

 Tray SP0
 Ø180 - 6 - 40

molded or machined buckets

8. Installation instructions

The SP0 part separator consists of a drive unit, a tray, the buckets and a control unit (see 5. Setup and production). The separator can be installed in different ways:

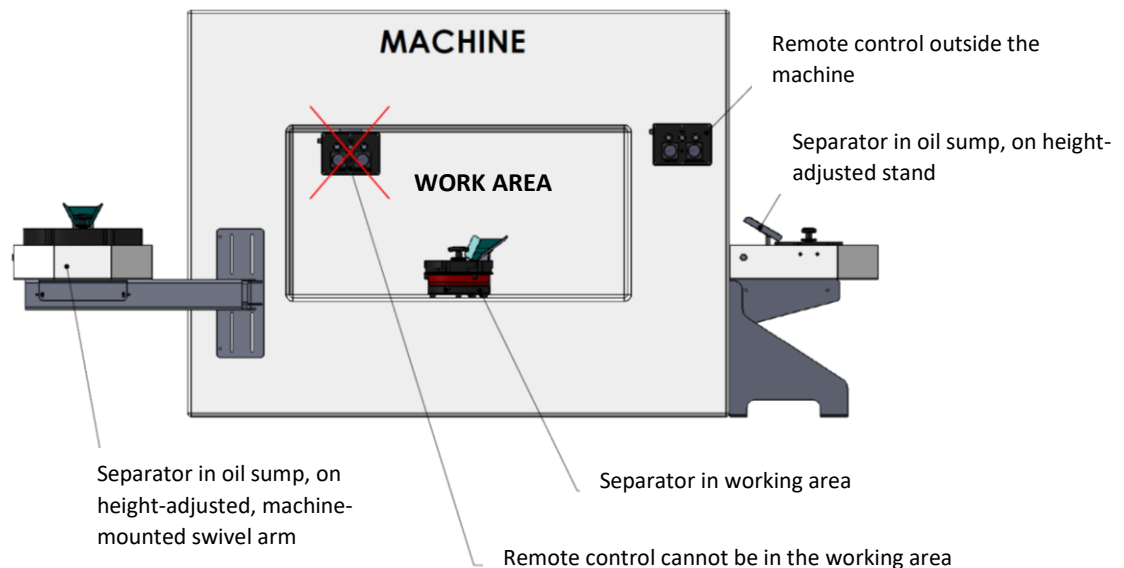

-Directly in the machine work area.

-Outside the machine at the conveyor outlet. In this case, it must be installed in an oil drip tray.

In both cases, the device can work submerged in oil, but cannot be immersed.

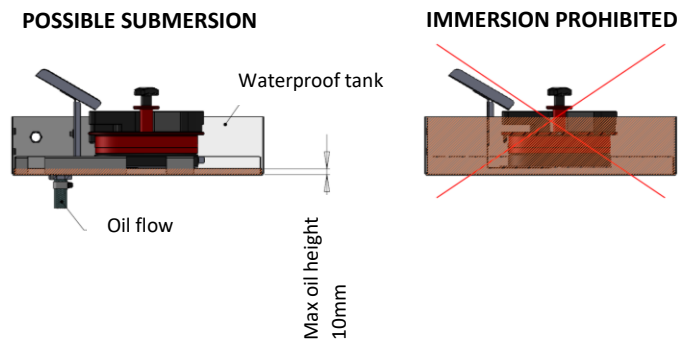

To limit the risk of tipping use the holes that are provided for this purpose on the ramp support.

It is necessary to install a power supply dedicated to the separator on the machine.

Voltage 24 Vdc, power 24w.

This power supply must be protected by thermal protection.

The power supply must be disconnected in the event of an emergency stop of the machine.

The control box must be located outside the machine.

It must not be exposed to oil splashes.

The bucket filling rate is programmed by the customer.

This must take into account the weight of the parts (in accordance with NF EN 1005).

9. Power On

Press the ON/OFF button located on the control box. The blue ring light indicates that the unit is powered.

10. Set up and production start up

- Remote control with timer.

- Touch-sensitive remote control.

(Please refer to the “TL.B.A ANDTL.T.A remote control” user manual).



11. Maintenance

Proper maintenance of the separator and replacement of worn parts is the responsibility of the customer and his maintenance personnel.

12. Power supply options

- Power cable kit Ref: TL.ALIM.24.C

For installation with a 24V power supply in the machine cabinet.

- 1 M12 5P cable lg: 5m female machine interface/wall feedthrough.
- 1 M12 bulkhead feedthrough
- 1 M12 5P cable lg: 3m male/female bulkhead interface/control box.

- Internal power supply kit Ref: TL.ALIM.24.I

For installation without a 24V power supply in the machine cabinet.

- 1 24V/2.5A power supply.
- 1 cable M12 5P lg : 5m Female interface Power/Bulkhead pass.
- 1 M12 bulkhead feedthrough
- 1 M12 5P cable lg : 3m Male/Female interface Bulkhead/control box.

- Kit Power Externe Ref: TL.ALIM.24.E

For installation with 220V plug.

- 1 cable with 24V transformer and 220V socket.

13. Accessories

- Retention bin SP0 Ref: SP0.A.00002-A

Dimensions 250mm x 250mm x 60mm

Oil return via Ø ext 16mm connection



- Support

remote control Ref: PF.09013-A

To be placed on the drip tray so that the housing is positioned above the SP1.

(Caution! Only valid for the rear magnet variant)



Adjustable foot Ref: SP0.A.00001-A

Dimensions Mini 250 x 260 x 403

Dimensions Maxi 250 x 260 x 837



14. Spare parts

| Designation | Qty | Supplier | Reference |
|----------------------|-----|----------|---------------|
| DOUBLE BLIND ROLLER | 3 | ERRIC | B.C-B608ZZ |
| ENGINE VMC 24V 0.25A | 1 | ERRIC | B.0132801143 |
| INDUCTIVE SENSOR | 1 | ERRIC | B.XS7J1A1DAL2 |

15. Electrical diagram

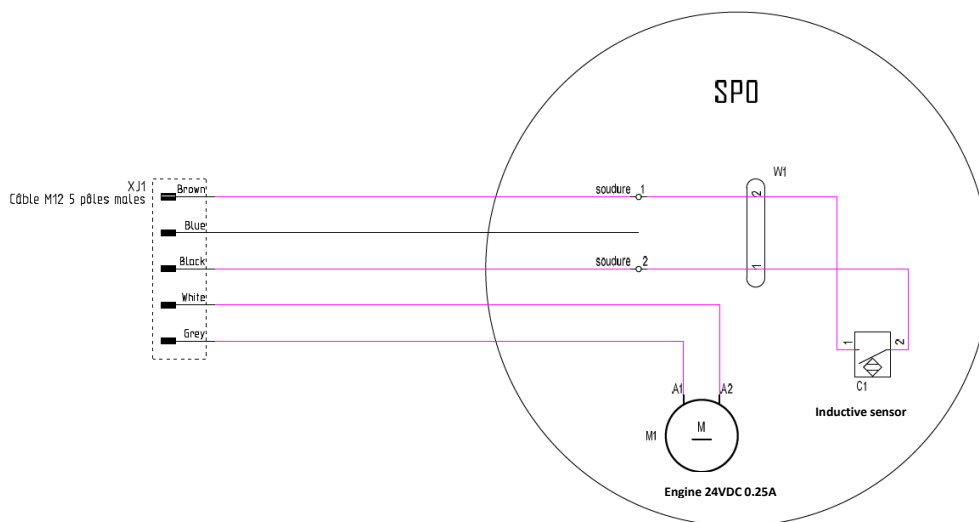

16. Safety

- Basic safety equipment (safety shoes, goggles) must be worn to limit the risk of injury from falling buckets or oil splashes during handling.
- Read the manual carefully before starting any operation.
- Never subject conveyors or auxiliary machines (e.g. turntables) to impact (e.g. hammering).
- Do not allow unauthorized access to electrical cabinets.
- Safety devices may only be dismantled by authorized personnel, and may only be replaced by an identical system.

- No unauthorized person may modify programs.
- Manual operation of the machine may only be carried out by trained personnel who have been made aware of the risks involved.
- Access to hazardous areas (actuators) is forbidden to any unqualified person.

17. Transport and handling

The SP0 bucket separator can be moved manually.

BARFIDE

Parts collector & Reduction tubes



Plaza del Vapor 7A - Pol. Les Guixeres

08915 Badalona (Barcelona)

Telf. 933 993 015

www.sumecsl.com

sumecsl@sumecsl